

162x90mm

30x9mm



E-200100

RJ45 Keystone Slimline, Cat.6A,
Zinkdruckguss, 10GE

1 Stück

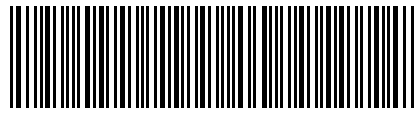

4049759186647

30x9mm

JACK PIN DESIGNATIONS	TIA / EIA T568A	TIA / EIA T568B
	1	White/Green
2	Green	Orange
3	White/Orange	White/Green
6	Orange	Green
4	Blue	Blue
5	White/Blue	White/Blue
7	White/Brown	White/Brown
8	Brown	Brown

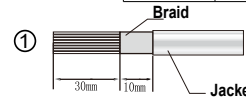

Strip off 1.2 inch of a cable jacket and fold braid back over it. Cut off aluminum foil for each pair.

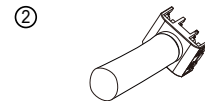
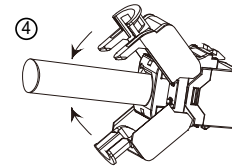

Insert a cable into the termination cap and fan out all four twisted pairs. Following the instruction of the color-coded wire position printed on the termination cap, position conductors into the slots and make sure the conductors are in the proper slot. Trim the ends of the conductors

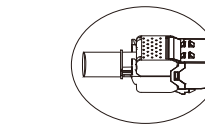

Secure the hinged outlet until it completely snap to effect the connection.

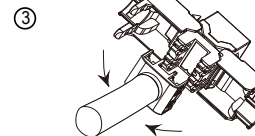

Install the termination cap to outlet, in direction of arrows, which will also allocate the conductors sitting on the slots.

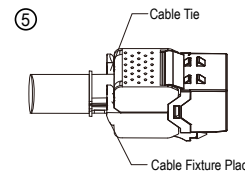

Fasten a cable tie wrap to secure the cable fixture place