



GVM-1101 Version: 1

Managebarer RJ45 zu SC Gigabit-Mediakonverte, Multi-Mode Fiber

Key-features

- IEEE-802.3x-Überwachung schützt vor verloren gegangenen Paketen und sorgt für zuverlässige Datenübertragung
- Webbasiertes und SNMP-Verwaltung
- Integrierte LFP- (Link Fault Pass-through) (LLCF/LLR) Technologie
- unterstützen VLAN (Tag-basiertes, Q-in-Q)

Specifications

System Specifications

Standards & Protocols:

IEEE802.3 10Base-T Ethernet
IEEE802.3u 100Base-TX Fast Ethernet
IEEE802.3ab 1000Base-T Giga Ethernet
IEEE802.3z 1000Base-X Giga Ethernet
IEEE802.3x Flow Control
IEEE802.3ah OAM

Connectors and Cabling:

1 x RJ45 Ethernet port,
1 x SC/ST/FC fiber connector

Wellenlänge (nm):

850nm

Indikator:

PWR (power supply),
FX LINK/ACT (optical link action)
FDX (full duplex),
TX LINK/ACT (TP cable link/action)
TX SPD (TP cable rate),
LFP(LFP function enable/disable)

Transmission Method:

store and forward or cut-through by software configure



Power Input:

internal: 100~240VAC in, 5V@2A output

Features

General:

1. 10/100/1000Mbps auto-sensed, facilitating network upgrade
2. Support LFP function
3. Built-in efficient switching core to implement flow control and reduce broadcast packets
4. Full-duplex and half-duplex auto-sensed
5. Support SC/ST/FC connector
6. Support Jumbo frame up to 9k bytes
7. Support Q-in-Q function, Optical port and Ethernet port can be set separately as dual Tag ports, and can be set as ISP Tag and ISP Tag TPID
8. Support configure the operation mode of each port on local and remote devices, including port speed, full/half-duplex, and flow control, etc, and can display the real-time status of each port
9. Support bandwidth-limiting function: with the step of 64kps, the bandwidth can be set between 0Mbps and 1000Mbps
10. Support 4 kinds of 802.3ah OAM functions: Discover of OAM, MIB variable response, OAM Loopback, Dying Gasp alarm
11. Offer MIB library files, support OpenView?Snmpc, and other softwares

Performance

Operating Distance:

500m

Environment

Temperatur (°C):

-10~55

Luftfeuchtigkeit (nicht kondensierend):

5%~90% non-condensing

Deployment:

Desk, Wall mounted

Physical Specifications

Abmessungen (W x D x H mm):

127mm×156mm×32mm

Gewicht:

720

Zuverlässigkeit

MTBF:

30000hours

Approval and Compliance

Zertifizierung:

CE, RoHS, FCC

Diagramm

Dimension Diagram

— Cat.5 UTP
— Fiber

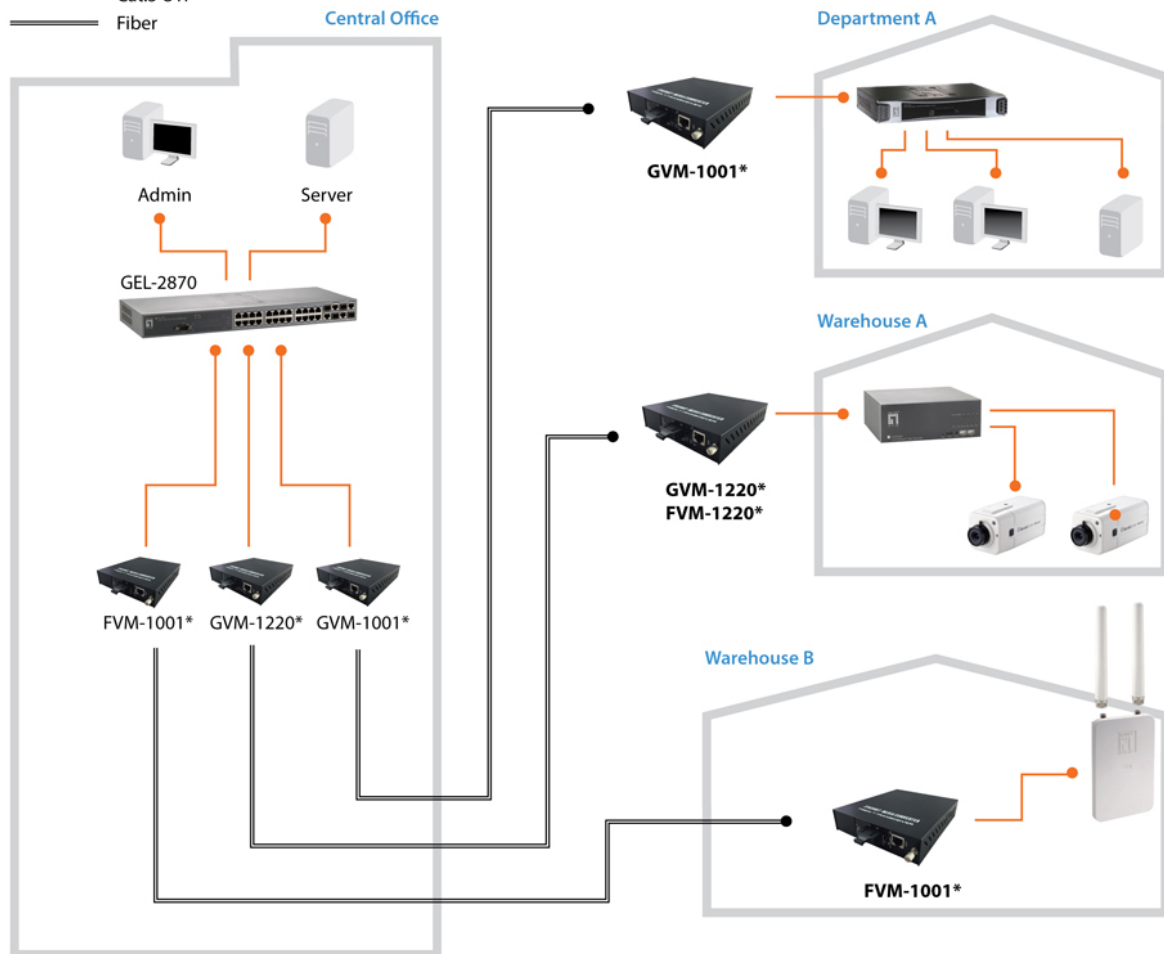

*In above example diagram, converter modules at local and remote ends should be paired for proper connectivity, and the distance mainly depends on cable and transceiver selection accordingly.

Order Information

GVM-1101

Package Contents

GVM-1101
Ressource CD (Bedienungsanleitung)

No liability or responsibility for any errors or omissions in the content.
Specifications are subject to change without notice.
All mentioned brand names are registered trademarks and property of their owners.
Copyright © Digital Data Communications GmbH, Germany. All Rights Reserved.