

# 19" WALL HOUSINGS FOLDABLE

## ASSEMBLY GUIDE

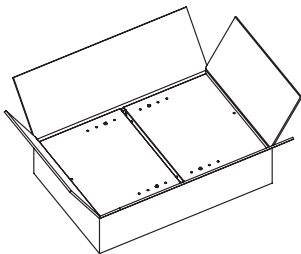

1

Open the box

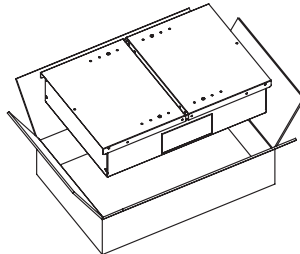

2

Take the wall housing out of the box and put in on the rear side

Width: 540 mm  
Depth: 450/600 mm

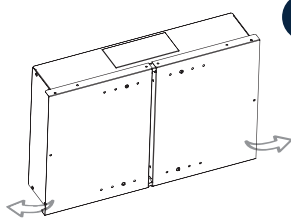

3

Fold-out the hinged side panels and take out the accessory parts from inside

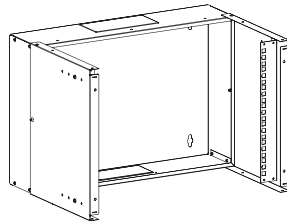

4

Assemble bottom sheet with special plastic rivets  
*Note: the bottom sheet has no fan cutouts*

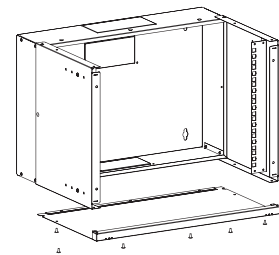

5

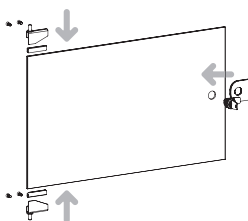

6

Hinges and lock parts are pre-assembled on the glass door  
*Note: take care not to damage the glass*

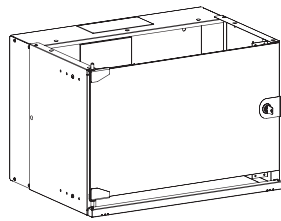

7

Fix the glass door to the bottom of the case

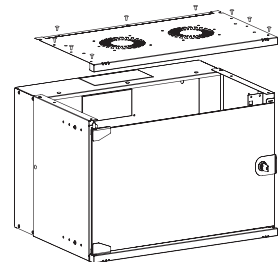

8

Assemble roof sheet with special plastic rivets  
*Note: the roof sheet has fan cutouts*

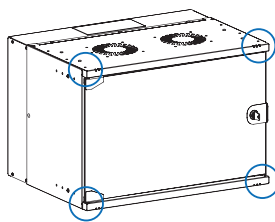

9

Bend the taps as shown in figure

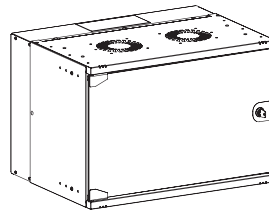

10

The wall housing now is ready to use